



**CUSTOMER:** \_\_\_\_\_ **DATE:** \_\_\_\_\_

**CONTACT:** \_\_\_\_\_ **PHONE:** \_\_\_\_\_ **FAX:** \_\_\_\_\_

### 1) APPLICATION

- INDOOR    OUTDOOR    MARINE ENVIRONMENT    MOBILE EQUIPMENT    OVERHEAD CRANE/HOISTING    CRANE CHAIR
- PORTABLE EQUIPMENT    FOOT PEDAL    OTHER \_\_\_\_\_

### 2) CONTROLLER SIZE & DURABILITY

- MINIATURE: V10 H100 H7 V14 V20 S14    MEDIUM: V11 V8 D8
- SMALL: V5 VV5 S2 S21 S22 S23 S24 N6    LARGE: V3 V6 VV6 D64 DD64 K2

### 3) CONTROLLER FUNCTIONS

SINGLE AXIS (PICK 1 OF 3 ITEMS BELOW)

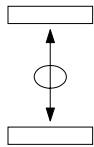

STANDARD BI-DIRECTIONAL

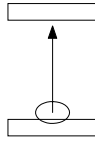

FULL TRAVEL UNI-DIRECTIONAL

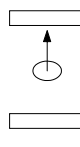

CENTER TO END UNI-DIRECTIONAL

DUAL AXIS

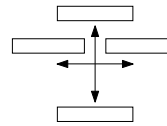

MULTI AXIS

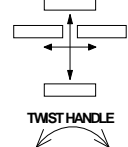

### 4) SWITCH SPECIFICATIONS

LEFT HAND MOUNTING

RIGHT HAND MOUNTING

- VOLTAGE \_\_\_\_\_ AC/DC      CURRENT \_\_\_\_\_ AMPS.  
 DIRECTION 1&2      DIRECTION 3&4  
 NUMBER OF CONTACTS \_\_\_\_\_      NUMBER OF CONTACTS \_\_\_\_\_  
 STEPLESS OR STEPS \_\_\_\_\_      STEPLESS OR STEPS \_\_\_\_\_
- SPRING RETURN       SPRING RETURN
  - FRICTION BRAKE       FRICTION BRAKE
  - POTENTIOMETER \_\_\_\_\_       POTENTIOMETER \_\_\_\_\_
  - ELECTRONICS       ELECTRONICS

- VOLTAGE \_\_\_\_\_ AC/DC      CURRENT \_\_\_\_\_ AMPS.  
 DIRECTION 5&6      DIRECTION 7&8  
 NUMBER OF CONTACTS \_\_\_\_\_      NUMBER OF CONTACTS \_\_\_\_\_  
 STEPLESS OR STEPS \_\_\_\_\_      STEPLESS OR STEPS \_\_\_\_\_
- SPRING RETURN       SPRING RETURN
  - FRICTION BRAKE       FRICTION BRAKE
  - POTENTIOMETER \_\_\_\_\_       POTENTIOMETER \_\_\_\_\_
  - ELECTRONICS       ELECTRONICS

### 5) ELECTRONICS

#### A) VALVE SPECIFICATIONS

VALVE MANUFACTURE \_\_\_\_\_ MODEL NUMBER \_\_\_\_\_

SUPPLY VOLTS: \_\_\_\_\_ VDC    COIL RESISTANCE: \_\_\_\_\_ OHMS    THRESHOLD: \_\_\_\_\_ mA    MAX. OUTPUT \_\_\_\_\_ mA

SINGLE COIL    DUAL COIL    FLOW CONTROL    SWITCHES FOR DIRECTIONAL VALVES    PWM FREQUENCY: \_\_\_\_\_ Hz

#### B) SIGNAL OUTPUTS

SUPPLY VOLTS: \_\_\_\_\_ VDC     4-20mA    0-20mA    0-10V    -10V to +10V    OTHER \_\_\_\_\_

#### C) OPTIONS FOR BOTH

SINGLE MAX. (A ADJ.)    DUAL MAX. (A & B ADJ.)    DUAL RANGE \_\_\_\_\_ mA    RAMP TIME \_\_\_\_\_ SEC.

### 6) HANDLE TYPE

- STANDARD KNOB    MECHANICAL INTERLOCK    PUSHBUTTON DEADMAN    PUSH DEADMAN    PULL DEADMAN
- PALM HANDLE \_\_\_\_\_

### 7) NAMEPLATE SPECIFICATIONS

- STANDARD NAMEPLATE \_\_\_\_\_
- SPECIAL NAMEPLATE (ATTACH LAYOUT DRAWING OR SPECIFICATIONS)

### 8) ENCLOSURE

- GENERAL PURPOSE    WEATHERPROOF    CORROSIVE RESISTANT (PLASTIC)    PORTABLE CONSOLES
- ENCLOSURE DIMENSIONS L= \_\_\_\_\_ W= \_\_\_\_\_ H= \_\_\_\_\_     TS1    TS2

### 9) NOTES

---



---



---

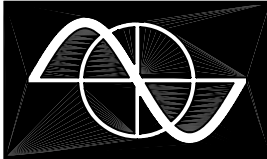

**SENETT  
CONTROL  
CO. LTD.**

# S23 SINGLE AXIS HUB TYPE CONTROLLER

**VER.3  
3.4.1**

THE S23 SINGLE AXIS MASTER SWITCH CAN BE USED FOR REMOTE CONTROL OF ELECTRO-HYDRAULIC PROPORTIONAL VALVES, VARIABLE SPEED DRIVES AND IS OF MODULAR DESIGN AND COMPACT SIZE.

IT IS BUILT FOR 6 MILLION OPERATIONS. THE S23 SWITCH IS OIL, OZONE, UV AND SALT ATMOSPHERE (OCEAN CONDITION) RESISTANT.

THE S23 HAS A RUGGED CAST HOUSING, WITH AN "O" RING SEAL.

THE S23 IS OBTAINABLE WITH A VARIETY OF MICROSWITCHES AND POTENTIOMETERS.

STANDARD CONTACT RATING 2A. 250V AC15 RES.

S23 DEGREE OF PROTECTION FRONT: IP65

3A. 24V DC13

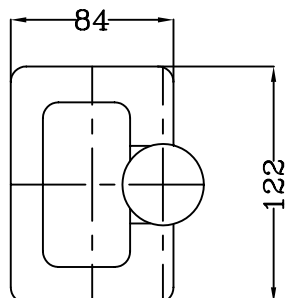
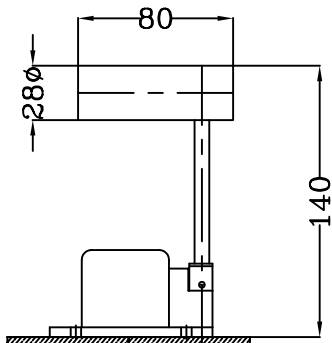
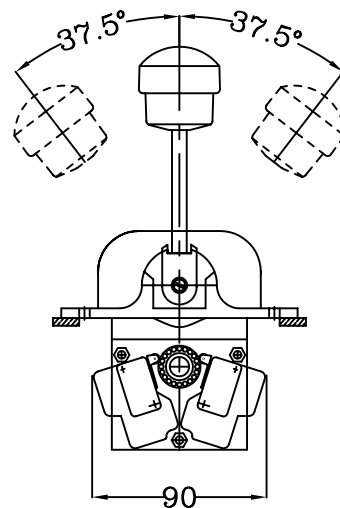
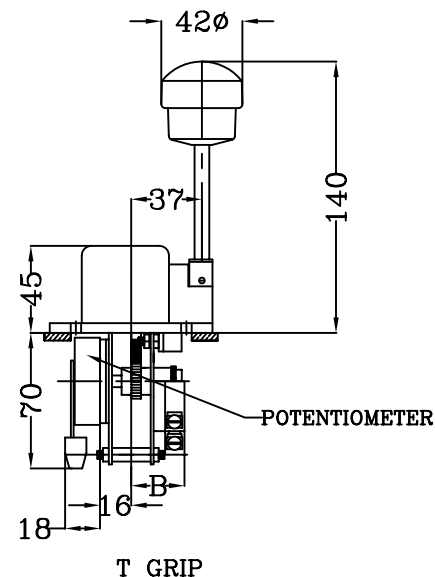

SIZE	# OF CONTACTS	B DIMENSION
1	1	25
2	2	31
3	3	36
4	4	42

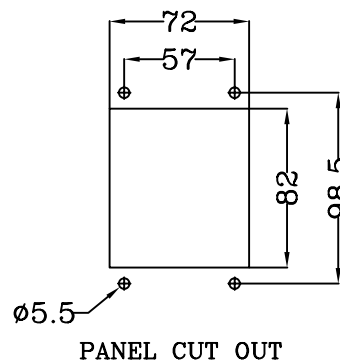

S2-MASTER SWITCH
S21-MASTER SWITCH
S22-MASTER SWITCH
S23-MASTER SWITCH HUB TYPE
S24-MASTER SWITCH
X-STANDARD HANDLE
T-DEAD MAN TO PRESS
P-DEAD MAN TO PULL
B-PUSH BUTTON IN HANDLE
M-MECH. INTERLOCK IN O POSS.
Q-T GRIP HANDLE (S23 ONLY)
SPECIAL HANDLE SEE SECT. 5
CONTACT ARR. DIR. 1-2
A-Z-FROM SHEET 20.2.1
O-SPECIAL CONTACT ARR.
X-IF NOT REQUIRED
Z-SPRING RETURN
F-BRAKE ADJUSTABLE
X-IF NOT REQUIRED
P-POTENTIOMETER SEE SECT. 6
p-POTENTIOMETER MOUNTING
X-IF NOT REQUIRED
1-M-STANDARD NAMEPLATE. SECT. 20.1
X-IF NOT REQUIRED
O-SPECIAL NAMEPLATE MARK IN CHART
G-GENERAL PURPOSE ENCL.
W-WEATHERPROOF ENCL.
O-OPEN TYPE SWITCH

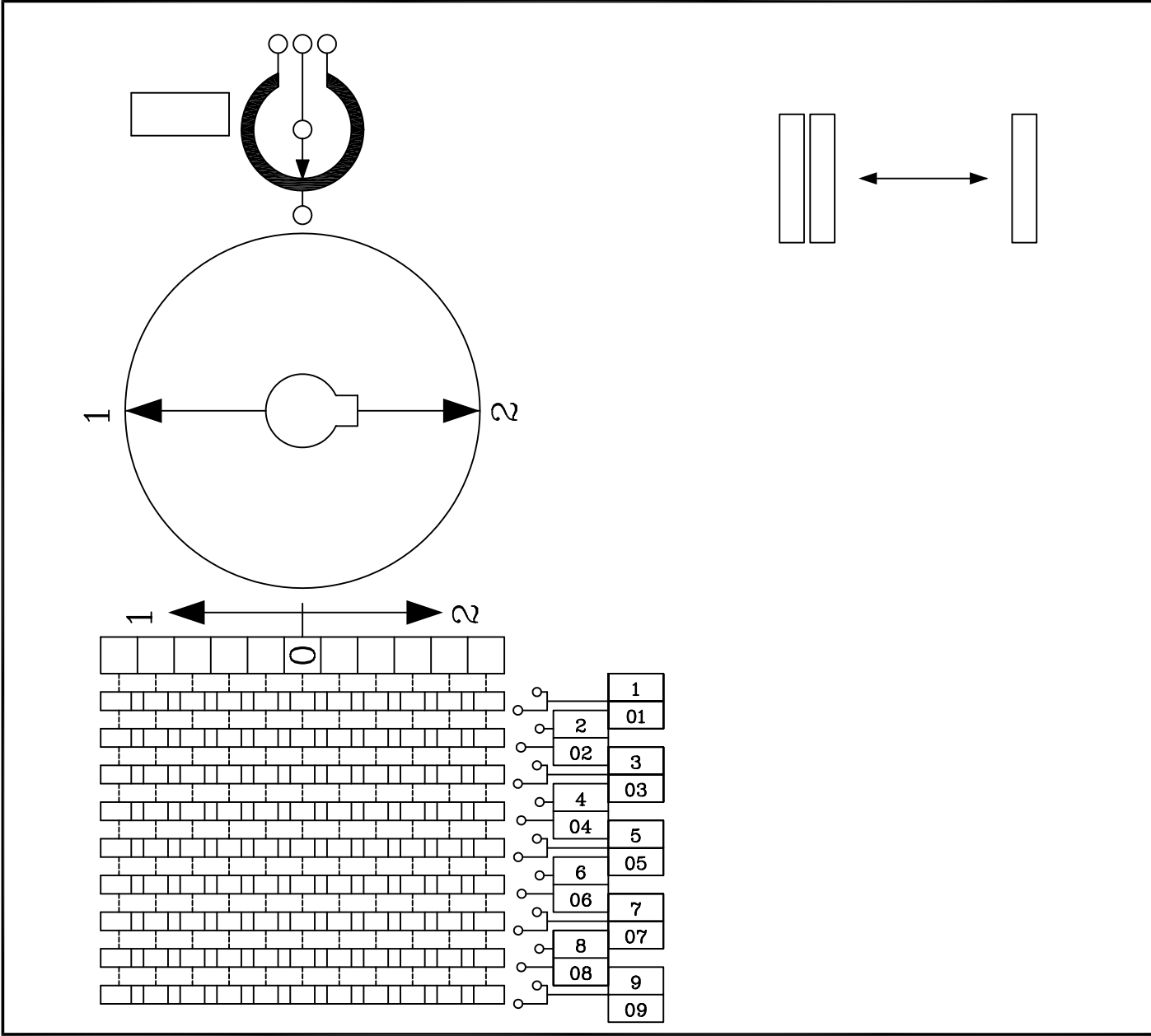
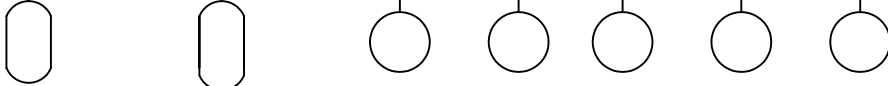

GESSMANN S___ MASTER SWITCH		JOB #
DATE: _____ NAME: _____	FROM: _____	_____

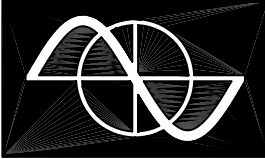

FOR THE REST OF THE PARTS REFER  
TO SECTIONS  
S2 & S22

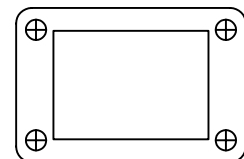
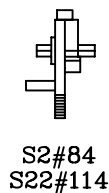
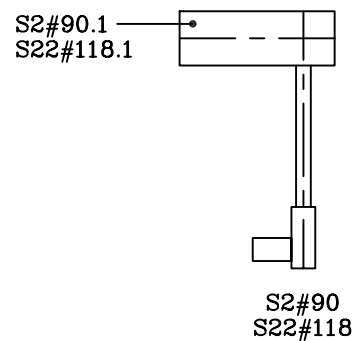
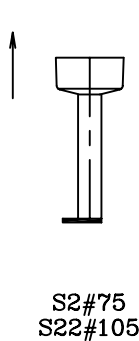
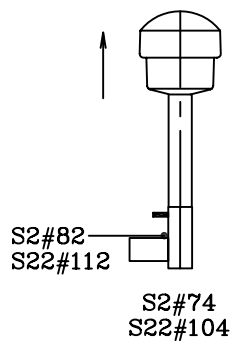
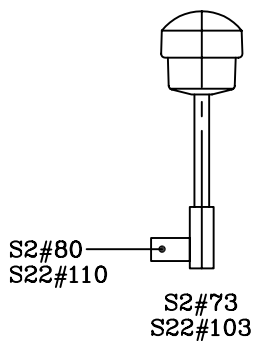
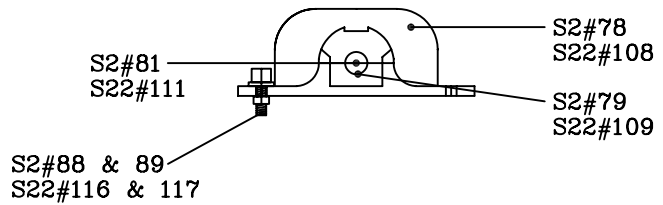
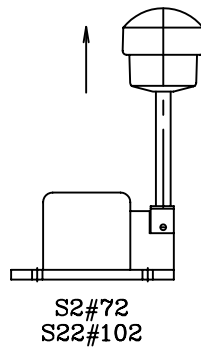
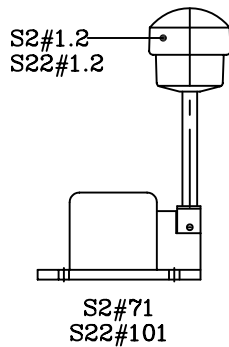



<b>S2</b>	<b>S22</b>	<b>DESCRIPTION</b>
1.1	1.1	SOLID KNOB
71	101	METAL HUB DRIVE WITH STANDARD HANDLE & RETURN SPRING
72	102	METAL HUB DRIVE WITH MECH.INTERLOCK & RETURN SPRING
73	103	STANDARD SHAFT ASSEMBLY
74	104	STANDARD SHAFT ASSEMBLY FOR MECHANICAL INTERLOCK 'M'
75	105	BOTTOM KNOB AND LEVER FOR PULL DEAD MAN 'P'
76	106	STANDARD SHAFT ASSEMBLY FOR MECHANICAL INTERLOCK
77	107	PLASTIC HEX MOUNTING SCREWS M5x15
78	108	'METAL HUB
79	109	BUSHING
80	110	SPACER
81	111	CHEESE HEAD SCREW M4x30
82	112	O' RING
83	113	CASTING
84	114	LARGE GEAR
85	115	CHEESE HEAD SCREW M4x35
88	116	M5 FLAT WASHER NYLON
89	117	HEX NUT M5
90	118	STANDARD SHAFT ASSEMBLY WITH 'T' GRIPHANDLE
90.1	118.1	T' GRIP HANDLE