



CUSTOMER: _____ **DATE:** _____

CONTACT: _____ **PHONE:** _____ **FAX:** _____

1) APPLICATION

- INDOOR OUTDOOR MARINE ENVIRONMENT MOBILE EQUIPMENT OVERHEAD CRANE/HOISTING CRANE CHAIR
- PORTABLE EQUIPMENT FOOT PEDAL OTHER _____

2) CONTROLLER SIZE & DURABILITY

- MINIATURE: V10 H100 H7 V14 V20 S14 MEDIUM: V11 V8 D8
- SMALL: V5 VV5 S2 S21 S22 S23 S24 N6 LARGE: V3 V6 VV6 D64 DD64 K2

3) CONTROLLER FUNCTIONS

SINGLE AXIS (PICK 1 OF 3 ITEMS BELOW)

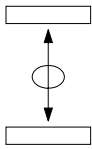

STANDARD BI-DIRECTIONAL

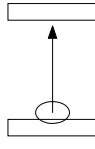

FULL TRAVEL UNI-DIRECTIONAL

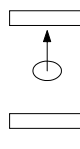

CENTER TO END UNI-DIRECTIONAL

DUAL AXIS

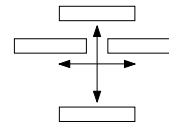

MULTI AXIS

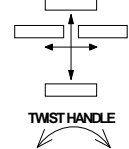

TWIST HANDLE

4) SWITCH SPECIFICATIONS

LEFT HAND MOUNTING

RIGHT HAND MOUNTING

- VOLTAGE _____ AC/DC CURRENT _____ AMPS.
 DIRECTION 1&2 DIRECTION 3&4
 NUMBER OF CONTACTS _____ NUMBER OF CONTACTS _____
 STEPLESS OR STEPS _____ STEPLESS OR STEPS _____
- SPRING RETURN SPRING RETURN
 - FRICTION BRAKE FRICTION BRAKE
 - POTENTIOMETER _____ POTENTIOMETER _____
 - ELECTRONICS ELECTRONICS

- VOLTAGE _____ AC/DC CURRENT _____ AMPS.
 DIRECTION 5&6 DIRECTION 7&8
 NUMBER OF CONTACTS _____ NUMBER OF CONTACTS _____
 STEPLESS OR STEPS _____ STEPLESS OR STEPS _____
- SPRING RETURN SPRING RETURN
 - FRICTION BRAKE FRICTION BRAKE
 - POTENTIOMETER _____ POTENTIOMETER _____
 - ELECTRONICS ELECTRONICS

5) ELECTRONICS

A) VALVE SPECIFICATIONS

VALVE MANUFACTURE _____ MODEL NUMBER _____

SUPPLY VOLTS: _____ VDC COIL RESISTANCE: _____ OHMS THRESHOLD: _____ mA MAX. OUTPUT _____ mA

SINGLE COIL DUAL COIL FLOW CONTROL SWITCHES FOR DIRECTIONAL VALVES PWM FREQUENCY: _____ Hz

B) SIGNAL OUTPUTS

SUPPLY VOLTS: _____ VDC 4-20mA 0-20mA 0-10V -10V to +10V OTHER _____

C) OPTIONS FOR BOTH

SINGLE MAX. (A ADJ.) DUAL MAX. (A & B ADJ.) DUAL RANGE _____ mA RAMP TIME _____ SEC.

6) HANDLE TYPE

- STANDARD KNOB MECHANICAL INTERLOCK PUSHBUTTON DEADMAN PUSH DEADMAN PULL DEADMAN
- PALM HANDLE _____

7) NAMEPLATE SPECIFICATIONS

- STANDARD NAMEPLATE _____ SPECIAL NAMEPLATE (ATTACH LAYOUT DRAWING OR SPECIFICATIONS)

8) ENCLOSURE

- GENERAL PURPOSE WEATHERPROOF CORROSIVE RESISTANT (PLASTIC) PORTABLE CONSOLES
- ENCLOSURE DIMENSIONS L= _____ W= _____ H= _____ TS1 TS2

9) NOTES

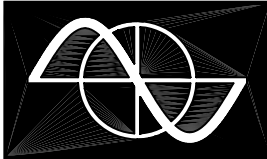

THE H7 SWITCH IS DESIGNED FOR RADIO AND PORTABLE CONTROLS. THEY ARE SMALL, LIGHTWEIGHT AND ARE SOLID IN DESIGN. IT IS BUILT FOR 3 MILLION OPERATIONS.

DEGREE OF PROTECTION: IP54

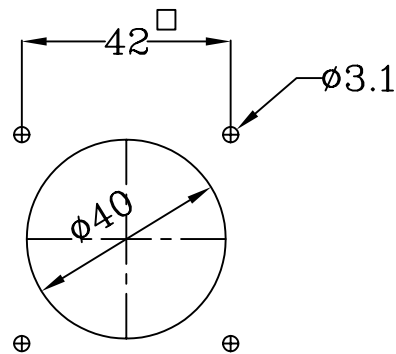
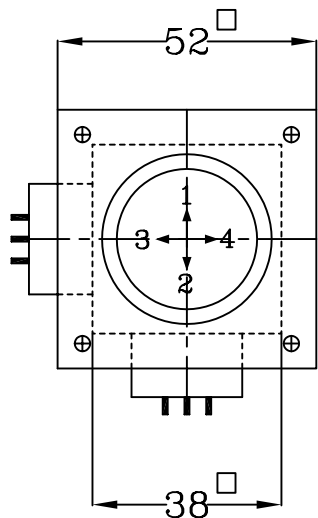
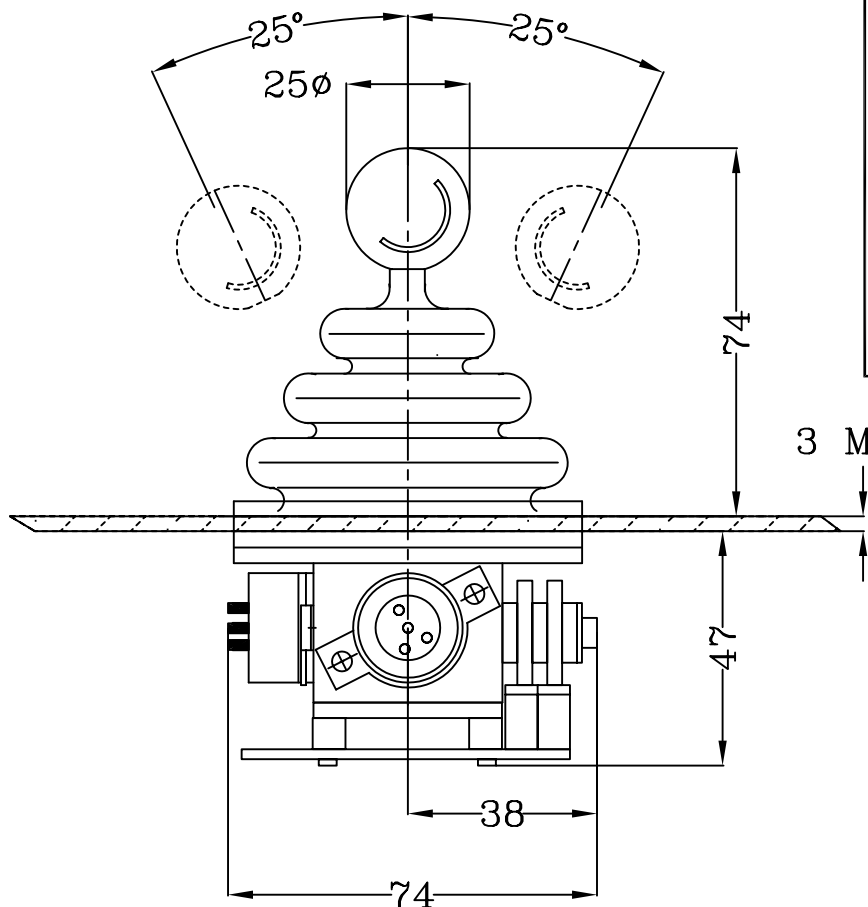

PANEL CUT OUT

H7	H7-BASIC MASTER SWITCH
	X-STANDARD HANDLE
	B-PUSH BUTTON IN HANDLE
	1-SWITCHING GATE #1 I
	2-SWITCHING GATE #2 +
	3-SWITCHING GATE #3 □
	4-SPECIAL SWITCHING GATE
	CONTACT ARR. DIR. 1-2
	A-Z-FROM SHEET 20.2.1
	O-SPECIAL CONTACT ARR.
	X-IF NOT REQUIRED
	Z-SPRING RETURN
	I-BRAKE ADJUSTABLE
	X-IF NOT REQUIRED
	P-POTENTIOMETER SEE SECT. 6
	X-IF NOT REQUIRED
	CONTACT ARR. DIR. 3-4
	A-Z-FROM SHEET 20.2.1
	O-SPECIAL CONTACT ARR.
	X-IF NOT REQUIRED
	Z-SPRING RETURN
	I-BRAKE ADJUSTABLE
	X-IF NOT REQUIRED
	P-POTENTIOMETER SEE SECT. 6
	X-IF NOT REQUIRED
	1-M-STANDARD NAMEPLATE. SECT. 20.1
	X-IF NOT REQUIRED
	O-SPECIAL NAMEPLATE MARK IN CHART
	G-GENERAL PURPOSE ENCL.
	W-WEATHERPROOF ENCL.
	O-OPEN TYPE SWITCH

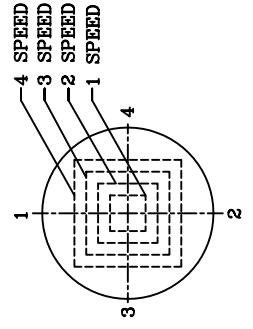

MARK IN SPECIAL SWITCHING GATE ONLY

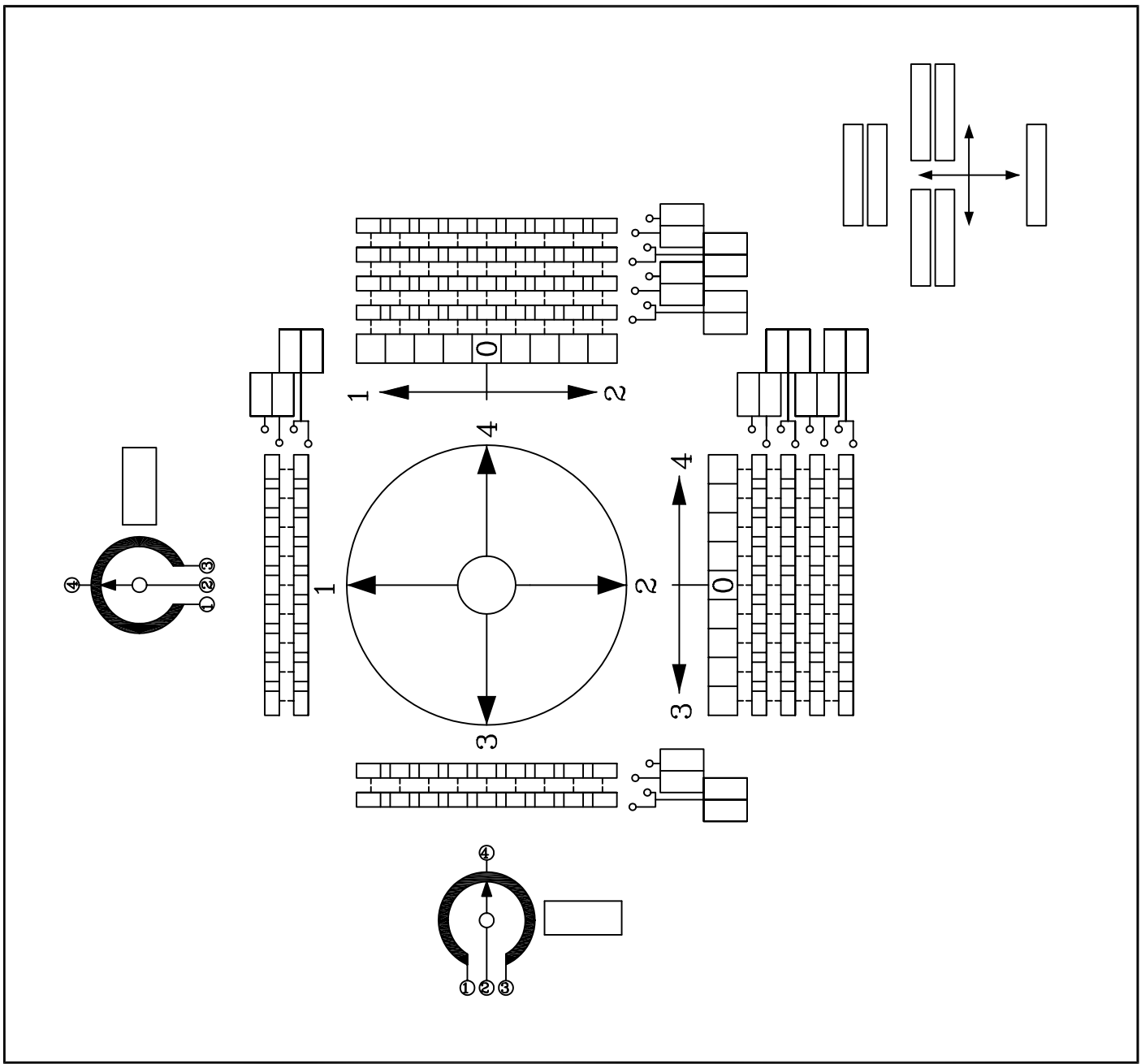

GESSMANN H7 MASTER SWITCH		JOB #
DATE:	FROM:	
NAME:		